

ProMax offers a wide range of 500+ professional Industrial Grade Switches for consumer, industrial, medical products and generic applications. These switches are specifically manufactured to offer best in class power ratings, build quality, and operation life. Designed to work in harsh conditions and environments.

Switches are available with inbuilt LED for status indication. Perfect for offering a neat user interface and clear usage.

ProMax Switches are available in multiple options - sizes, colour indication, customisable symbols, power ratings, button head types, metal finishes, etc

Features

- Available Sizes: 8mm, 10mm, 12mm, 16mm, 19mm, 22mm, 30mm, 42mm
- Switch Available in Resetting and Non Resetting Modes
- LED Operating Voltage: 3V, 5V, 12V, 24V, 240V AC/DC
- Max Load Switching Voltages: 300V AC, 100V DC
- Max Load Switching Current: 3A to 15A (depending on model)
- Ingression Protection Rating: IP65 Dust and Waterproof
- Simple and Easy Panel Mounting. Offers professional finish after mounting
- Low Electrical Noise during switching
- Illuminations Symbol: Ring or Power Symbol
- Multiple switch head option: Raised, Flat and Lowered
- Customisation available based on customer requirement
- Switch Operating Cycles MTBF: 1,00,000 cycles
- LED Minimum Life: 50,000 working hours



Applications

- Perfect Replacement for traditional switches where switch status is to be indicated to users
- Automobile Dashboards and Panels. Consumer & Medical Products
- Industrial Control Panels. Elevator, Lift, Crane Controls
- Generic System start/stop applications. Emergency Stop Switches
- Suitable for generic load switch and switch status indication

Table of Contents

Features	1
Applications	1
Table of Contents	2
1. Technical Specifications	3
2. Ordering Information	4
3. Dimensions	6
3.1 PPS12 Dimensions	6
3.2 PPS16	7
3.3 PPS19	8
3.4 PPS22	9
4. Pinout	11
5. Application Diagram	12
6. Symbol Customisation Options	14

1. Technical Specifications

Operating Temperature range	-20°C to +55°C
Storage Temperature	-40°C to +85°C
Max Load Switching Voltage	300V AC / 60V DC
Max Load Switching Current	3A (5A & 15A available upon order)
LED Operating Voltage	Available in 3V/5V/6V/12V/24V/240V
Max LED Current	20mA
Thread sizes	12-45mm
Pre-travel	Approx 1.5
Contact travel	Approx 2.5
Operating force	max. 5N
Mechanical life	100.000 cycles
Frequency max.	100/min
Voltage range	9VDC - 32VDC
Mechanical Life	>100,000 operations
Operations Electrical Life	>50,000 working hours
Operations Motion Tolerance	< 30 Operations/Minute
Degree of Protection	IP65
Supported Mounting Panel Thickness	0.5mm to 5mm
Mounting Torque	4 to 15 N-m
Maximum Insulation Voltage	1500 VAC 60Hz, 10mA, 1 Minute Insulation
Resistance	100MΩ @500 VDC, 100mA, 1 minute
Contact Resistance	<= 50 mΩ

2. Ordering Information

PPS	XX	VVV	C	S	O -	1	1	S	S	B	L
ProMax Push Switch	Size	LED Voltage	LED Color	Symbol	Operation Type	NC	NO	Head	Body Color	Contact Material	Terminal Style

Ex. Part No: **PPS16006GPL-11FSNP** is ProMax Push Switch 16mm with 6V LED Illumination, Power Symbol, Latching Operation with 1NO, 1NC, Flat Head, Stainless Steel Silver Body, Nickel plated, with crimp pins.

Above Part Code	Description and Possible Values	Possible Values
ProMax Push Switch	Identifies part as ProMax's Push Switch	PPS
Size	Indicates the Mounting Thread Diameter. Hole Diameter for Panel Mounting.	12 = 12mm 16 = 16mm 22 = 22mm 30 = 30mm 42 = 42mm
LED Voltage	Operating Voltage of LED	006 = 3 to 6V DC 012 = 8 to 12V DC 024 = 19 to 24V DC 240 = 220 to 240V AC 000 = No LED. Not Applicable
LED Color	Illumination Color of the Switch LED	G = Green R = Red B = Blue Y = Yellow W = White A = RGB N = No LED. Not Applicable
Symbol	Laser Cut Symbol on the Switch Head	P = Power Symbol R = Ring Symbol B = Both Power & Ring Symbol C = Customised N = No Symbol. Not Applicable
Operating	Switch Operation Type	M = Momentary. Resetting Switch. Push to turn On.

Type		Release to turn Off L = Latching. Self Locking Switch. Push to On, push to Off
NC	No of NC Terminals	0 = No NC Terminals 1 = 1 NC Terminal 2 = 2 NC Terminals
NO	No of NO Terminals	0 = No NO Terminals 1 = 1 NO Terminal 2 = 2 NO Terminals
Head	Switch Head Type	F = Flat Head in OFF State R = Raised Head in OFF State L = Recessed Head in OFF State M = Mushroom Head in OFF State
Body Color	Primary Material and Color of outer body	S = Stainless Steel, Silver B = Stainless Steel, Black
Contact Material	The Material of internal Contacts. Determines Swith Load Rating and Performance	
Pin Terminal Style	Indicates the termination style of the pin	C = Crimp Terminal. Solder Tab. P = Screw Terminal W = Wire

3. Switch Physical Dimensions

3.1. ProMax PPS12 Switch Series Dimensions

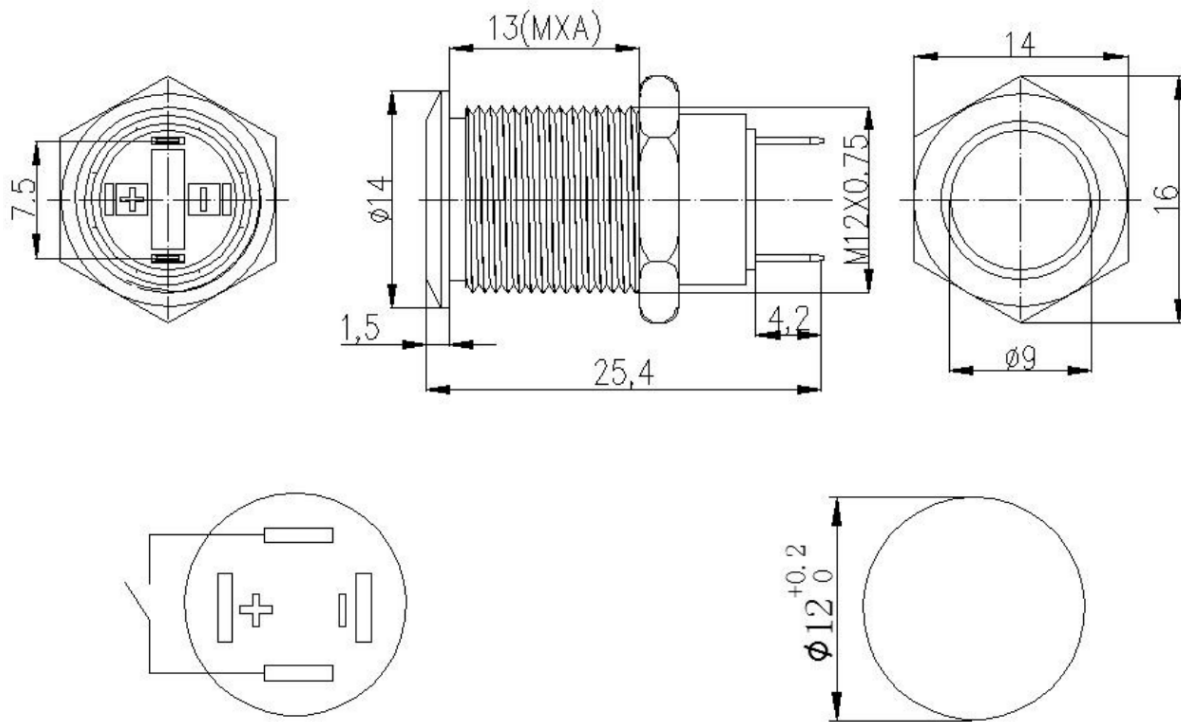

3.2. PPS16 Switch Series Dimensions

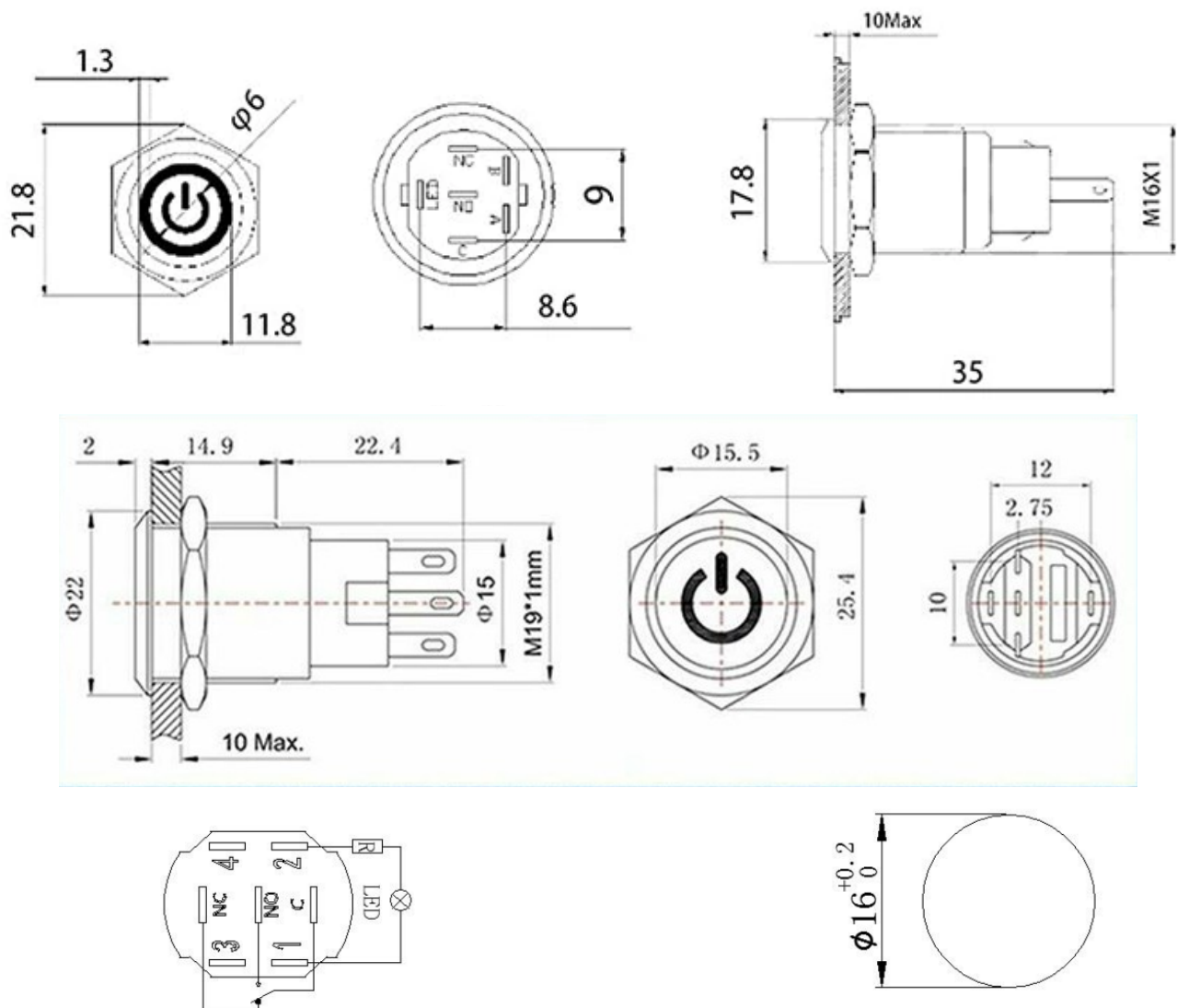

3.3. PPS19 Switch Series Dimensions

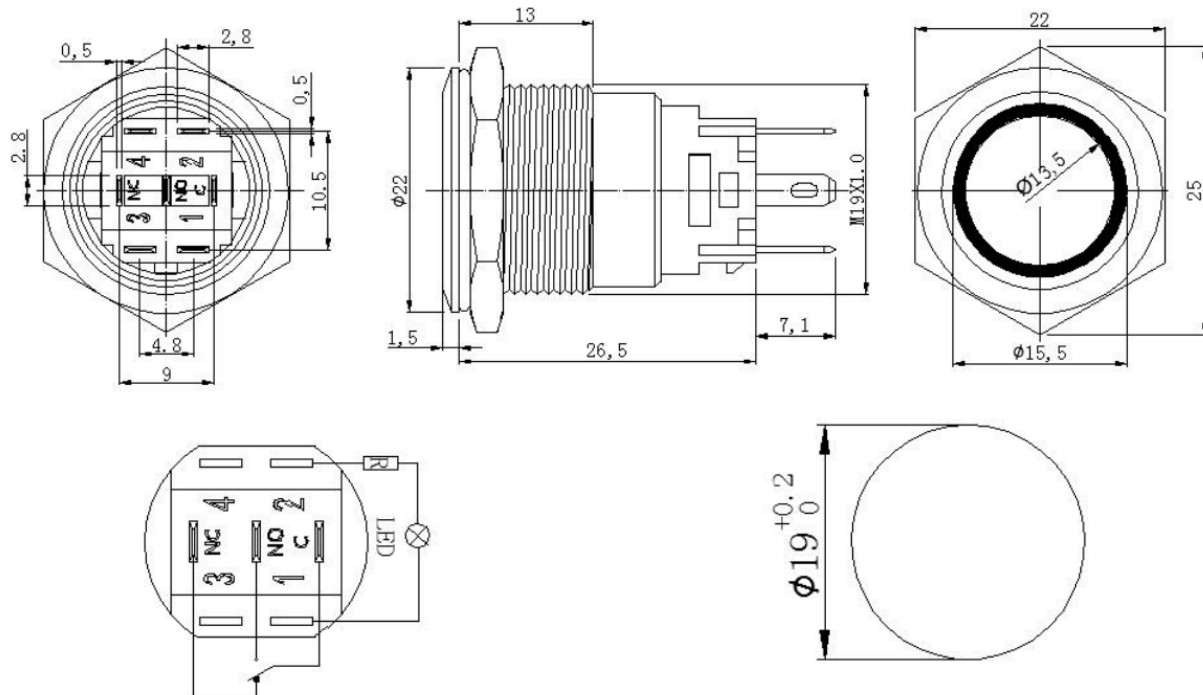

3.4. PPS22 Switch Series Dimensions

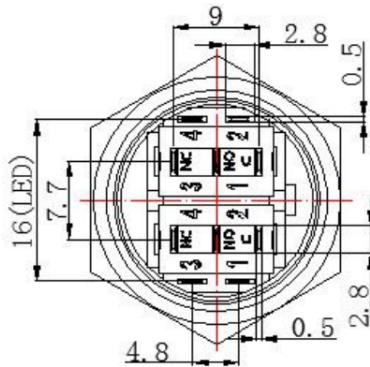

电气简图

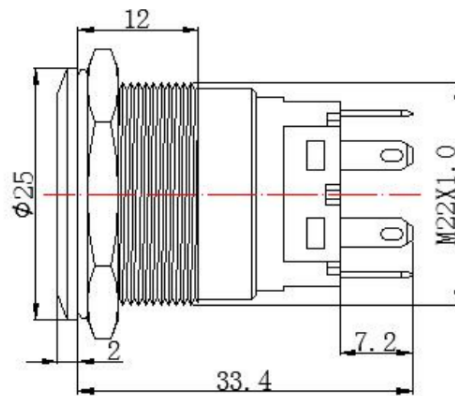

安装孔图

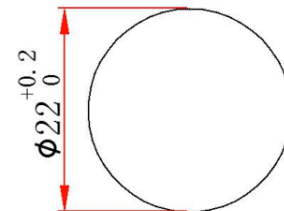
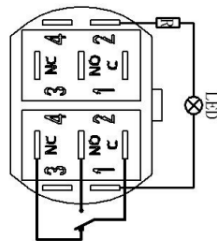
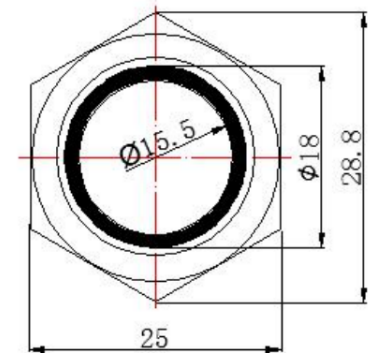

PPS16-XXX-X-PX11FXXP Dimensions

4. Pinout

 <p>Backside View</p>	Pin Marking	Description
	LED	Power Supply for LED Illumination
	LED	Power Supply for LED Illumination
	C	Switch Common Contact
	NO	Switch Normally Open Contact. This pin is internally connected to Common Contact only when is Open
	NO	Switch Normally Open Contact. This pin is internally connected to Common Contact only when is Open

5. Application Diagram

Wiring diagram1:

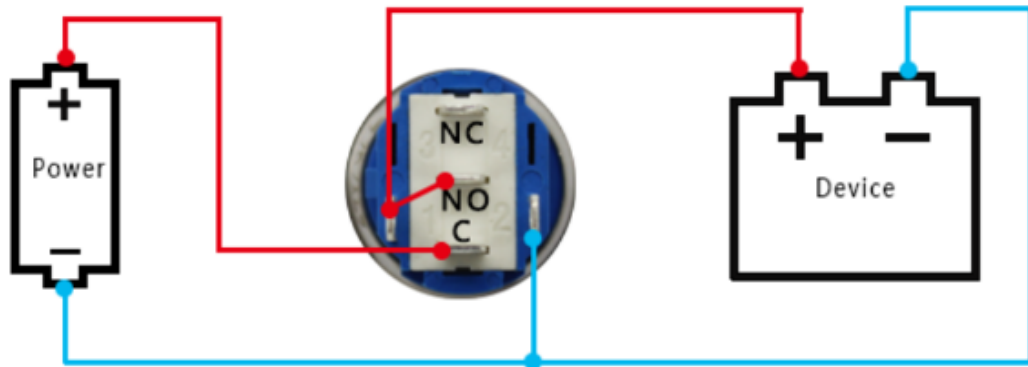

Wiring diagram1:

Light: NOT Working, Switch: Opened

When you **Press** the button, Light: Working, Switch: Closed

Wiring diagram2:

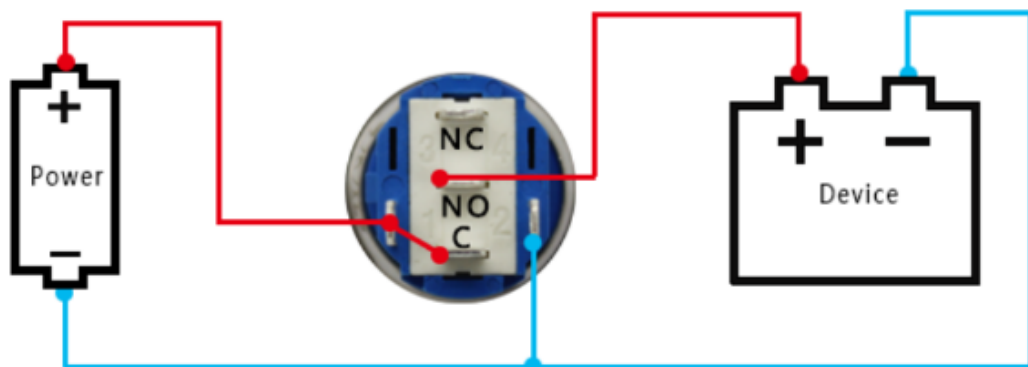

Wiring diagram2:

Light: Working, Switch: Opened

When you **Press** the button, Light: Working, Switch: Closed

Wiring diagram3:

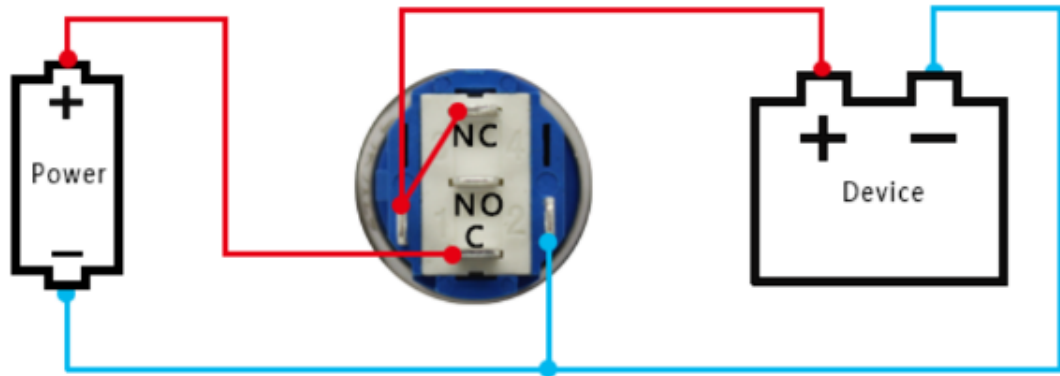

Wiring diagram3:

Light: Working, Switch: Closed.

When you **Press** the button, Light: Not Working, Switch: Opened

Wiring diagram4:

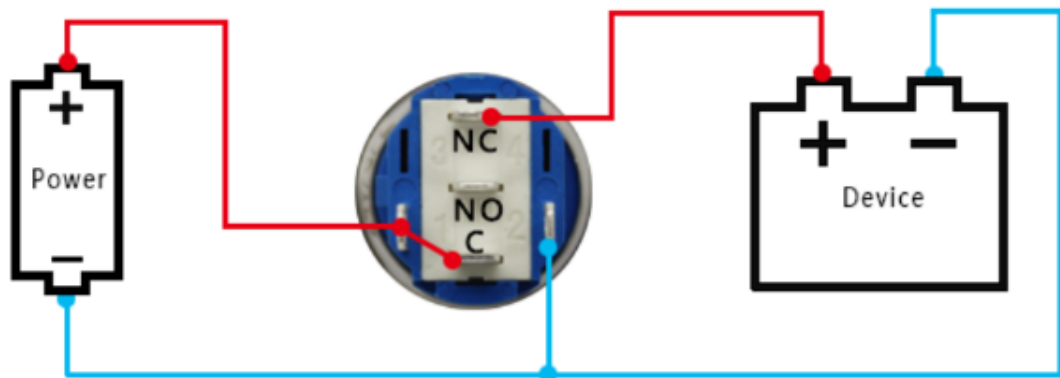

Wiring diagram4:

Light: Working, Switch: Closed

When you **Press** the button, Light: Working, Switch: Opened

6. Symbol Customisation Options

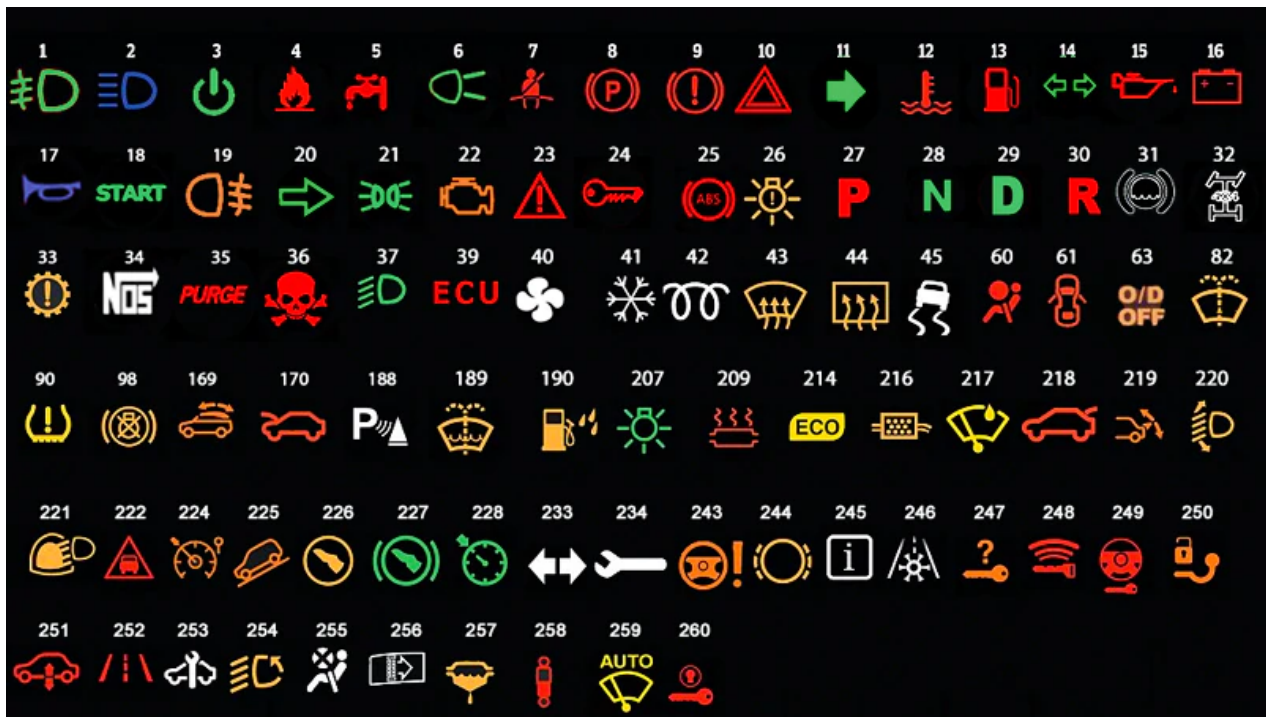

Terms and Conditions Agreement

Read and understand this catalog.

Please read and understand this catalog before purchasing the products. Please consult your ProMax sales/technical representative if you have any questions or comments.

Warranties.

(a) Warranty. ProMax's does not offer any warranty/guarantee/replacement/returns for products once sold. Since these products are used in research/testing/production with other components, it is beyond our scope to determine the working of our product in your application. ProMax disclaims all other warranties, express or implied.

(b) Limitations. ProMax MAKES NO WARRANTY OR REPRESENTATION, EXPRESS OR IMPLIED, ABOUT NON-INFRINGEMENT, MERCHANTABILITY OR FITNESS FOR A PARTICULAR PURPOSE OF THE PRODUCTS. BUYER ACKNOWLEDGES THAT IT ALONE HAS DETERMINED THAT THE PRODUCTS WILL SUITABLY MEET THE REQUIREMENTS OF THEIR INTENDED USE.

ProMax further disclaims all warranties and responsibility of any type for claims or expenses based on infringement by the Products or otherwise of any intellectual property right.

(c) Buyer Remedy. ProMax sole obligation hereunder shall be, at ProMax's election, to (i) replace (in the form originally shipped with Buyer responsible for labor charges for removal or replacement thereof) the non-complying Product, (ii) repair the non-complying Product, or (iii) repay or credit Buyer an amount equal to the purchase price of the non-complying Product; provided that in no event shall ProMax be responsible for warranty, repair, indemnity or any other claims or expenses regarding the Products unless ProMax analysis confirms that the Products were properly handled, stored, installed and maintained and not subject to contamination, abuse, misuse or inappropriate modification or any other reason. Return of any Products by Buyer must be approved in writing by ProMax before shipment. ProMax Companies shall not be liable for the suitability or unsuitability or the results from the use of Products in combination with any electrical or electronic components, circuits, system assemblies or any other materials or substances or environments. Any advice, recommendations or information given orally or in writing, are not to be construed as an amendment or addition to the above warranty. See <http://www.probots.co.in/> or contact your ProMax representative for published information.

Limitation on Liability; Etc.

ProMax COMPANIES SHALL NOT BE LIABLE FOR SPECIAL, INDIRECT, INCIDENTAL, OR CONSEQUENTIAL DAMAGES, LOSS OF PROFITS OR PRODUCTION OR COMMERCIAL LOSS IN ANY WAY CONNECTED WITH THE PRODUCTS, WHETHER SUCH CLAIM IS BASED IN CONTRACT, WARRANTY, NEGLIGENCE OR STRICT LIABILITY.

Further, in no event shall liability of ProMax Companies exceed the individual price of the Product on which liability is asserted.

Suitability of Use. ProMax Companies shall not be responsible for conformity with any standards, codes or regulations which apply to the combination of the Product in the Buyer's application or use of the Product. At Buyer's request, ProMax will provide applicable third party certification documents identifying ratings and limitations of use which apply to the Product. This information by itself is not sufficient for a complete determination of the suitability of the Product in combination with the end product, machine, system, or other application or use. Buyer shall be solely responsible for determining appropriateness of the particular Product with respect to Buyer's application, product or system. Buyer shall take application responsibility in all cases.

NEVER USE THE PRODUCT FOR AN APPLICATION INVOLVING SERIOUS RISK TO LIFE OR PROPERTY OR IN LARGE QUANTITIES WITHOUT ENSURING THAT THE SYSTEM AS A WHOLE HAS BEEN DESIGNED TO ADDRESS THE RISKS, AND THAT THE ProMax PRODUCT(S) IS PROPERLY RATED AND INSTALLED FOR THE INTENDED USE WITHIN THE OVERALL EQUIPMENT OR SYSTEM.

Programmable Products.

ProMax Companies shall not be responsible for the user's programming of a programmable Product, or any consequence thereof. Performance Data.

Data presented in ProMax Company websites, catalogs and other materials is provided as a guide for the user in determining suitability and does not constitute a warranty. It may represent the result of ProMax's test conditions, and the user must correlate it to actual application requirements. Actual performance is subject to the ProMax's Warranty and Limitations of Liability.

Change in Specifications.

Product specifications and accessories may be changed at any time based on improvements and other reasons. It is our practice to change part numbers when published ratings or features are changed, or when significant construction changes are made. However, some specifications of the Product may be changed without any notice. When in doubt, special part numbers may be assigned to fix or establish key specifications for your application. Please consult with your ProMax's representative at any time to confirm actual specifications of purchased Product. Errors and Omissions. Information presented by ProMax Companies has been checked and is believed to be accurate; however, no responsibility is assumed for clerical, typographical or proofreading errors or omissions.